

Waikato Header Sheet



11083

Box Name: EKMT-00017

Subject: 54/16/0/5 (Vol.1) - Reclamation - Coromandel Peninsula Area (1982-1983)

54/16/0/5
WIL 22/3/2

25 February 1983

Director
Wildlife Service
Department of Internal Affairs
Private Bag
WELLINGTON

Attention: Miss J.C. Anderson

**RECLAMATIONS AND RUBBISH TIPS ON TIDAL LAND
COROMANDEL PENINSULA**

Your memorandum of 15 February 1983 refers.

This ministry has drawn to the notice of the Thames-Coromandel District Council the policies of the ministry in respect of reclamations of the foreshore.

Also, the ministry has discussed the matter of road reclamations with the Ministry of Works and Development and will during this year prepare joint guidelines for MWD officers.

T.E. Law
for Secretary for Transport

B/u *decker*
300

file

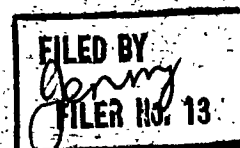

EO(H&F)

54/16/0/5



Please Quote
WIL 22/3/2

WILDLIFE SERVICE
DEPARTMENT OF INTERNAL AFFAIRS

Private Bag, Wellington, N.Z.

Telephone 738-699

Telegrams and Cables 'Internal'

15 February 1983

Harbours and Foreshore Division
Ministry of Transport
Private Bag
WELLINGTON

Attention: Mr T E Law

RECLAMATION AND RUBBISH TIPS ON TIDAL LAND - COROMANDEL PENINSULA

I refer to your memo of 1 September regarding the above, your reference 54/16/0/5.

Could you please advise whether progress has been made with this matter.

I look forward to your reply.

(Joan C Anderson, Miss)
for Director, Wildlife Service

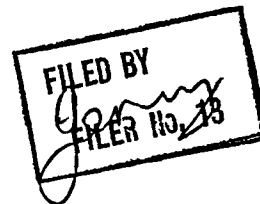

file

54/16/0/5

54/1/722

Regional Secretary

HEAD OFFICE

AUCKLAND

3 December 1982

THAMES COROMANDEL DISTRICT COUNCIL : SLIPWAY WIDENING

Previous correspondence refers.

This matter was referred to our Legal Section who do not support the taking of prosecution action for the above work which has been carried out. No further action will be taken concerning this work.

In early 1983, the ministry will be writing to the National Organisations of Local Authorities (Counties Association, Municipal Association, Catchment Boards etc) to draw their attention, and the attention of their members to the requirements of the Harbours Act 1950.

49-
T.E. Law
for Secretary for Transport

B/U 1/2/83 ✓

3/11
A/RO(H&P)

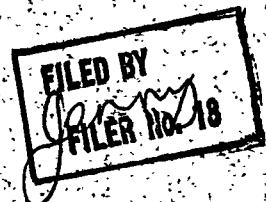

B/U again

4/3/83 ✓

again 4/5/83

file



MINUTE SHEET

Department: MOT AK

Subject: Thames Coromandel District
Council Slipway Widening

Section: H.F

File No. 54/11/722

Date: 10-11-82

77886H-45 pad 2/82MK

To-

HEAD OFFICE
~~SEO HRS~~

Attention: TLAN

A/EO H.F

Further to our previous memo's regarding the
above works.

Could you please advise us of what action is
proposed (if any)?

Andy Emerson

B.M. Emerson

For Regional Secretary for Transport



MINUTE SHEET

Department: M.O.T. AK

Subject: THAMES COROMANDEL DISTRICT
COUNCIL & SLIPWAY WIDENING

Section: H & F

File No: 541/122

Date: 1.10.82

49918A-150 pads/7/80 MK

To-

HEAD OFFICE

S.E.O HERS

Attention: T. LAW

Further to our memorandum of 6 August 1982
regarding the above works.Could you please advise us of what action is proposed
(if any)?

B.M. Emerson

Candy Emerson

To: Regional Secretary R. Transport

File

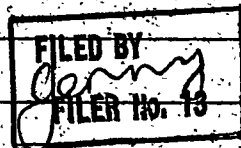

Legal M.

Is there sufficient information for a prosecution to be taken? The letter from TCDC has admitted work has commenced.

I understand that a warning letter has been sent to the council on another occasion previously.

30 cm

A/EO (H&F)

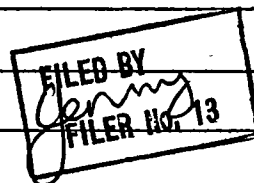

A/EO (H&F)

15/4/82

28/9.

What are the merits of this thing? Is the granting of approval in due course a formality or are there matters of substance to be investigated as to the design bearing in serious question of the public interest? Can it be said that we ourselves have a record of allowing to those approval promptly or has there been a history of local bodies etc. taking for granted that no action will be taken against them provided that at some stage of construction the 178(b) procedure is followed albeit late?

file

We are in big trouble with the Ombudsman over a prosecution of this kind and query what will be achieved here. Perhaps a public statement ^{by the Sec or Municipal Comm.} sent to the likely instigator of the case via Municipal, counties or other associations would do some good at this point. The message would be that MOT will seriously consider prosecuting all cases such as this whilst undertaking to deal within, say, 2 months with these applications. *Shut AOS*

MINUTE SHEET

Department: MoT

Subject: Thames Commanded Portland Cement Section: H&F

File No. 5A/14/0/5

Thames.

Date: 12/8/82

49918A-15 pads/7/80 MK

To-

Legal

Papers below refer.
I do not see that even though TCDC have admitted commencing the work without obtaining prior approval that much would be achieved by prosecuting.

I recommend that a letter of warning signed by the OS would be more appropriate. Could I see how your committee.

File

9C can

A/EO(H&F)

FILED BY
Gerry
FILER NO. 13

A/EO(H&F) I think we should prosecute but it's not for me to say. Decision is usually made by CCMP. If there is to be a warning letter it should be signed by the Secretary not by me. OC OS 17/8



MINISTRY OF TRANSPORT



SEO (H&F)

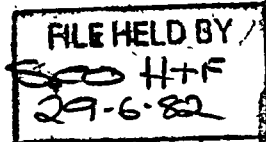

MOT 5

Our Ref: 54/1/722

Your Ref:

INTERNAL MEMORANDUM

To: SEO HBRS
HEAD OFFICE

From: Regional Office, Auckland

Attention: Miss Ranger

Date: 6 August 1982

Subject: THAMES COROMANDEL DISTRICT COUNCIL : SLIPWAY WIDENING

... Enclosed for your information is correspondence and plans received from Thames Coromandel District Council for additions to a slipway which have already commenced.

The Thames Coromandel District Council persistently carry out works prior to approval being granted. Because of this that we have referred this matter to you so that consideration can be given to possible legal action.

Please advise us further.

P. D. Spackman
for Regional Secretary

Encl:

P.S. PERHAPS A STERN WARNING WOULD SURFACE.

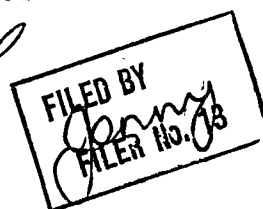

file

PDH/RCF



PLEASE ADDRESS ALL CORRESPONDENCE TO: THE GENERAL MANAGER,
PRIVATE BAG, THAMES, N.Z.

In calling, please ask for
MR HIGGS
Please quote reference.
V3/2

20 July 1982

Regional Secretary for Transport,
Marine Division,
Ministry of Transport,
Private Bag,
AUCKLAND

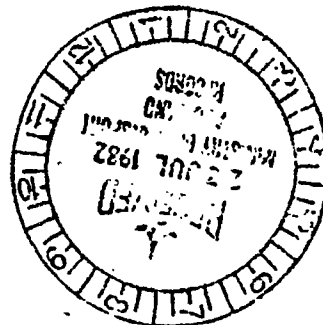

Dear Sirs,

THAMES HARBOUR - SLIPWAY WIDENING

Approval is sought, in terms of Section 178 (b) of the Harbours Act, for the widening of the Thames harbour slipway. Enclosed in duplicate are drawings detailing the proposal.

The two un-numbered drawings show the existing slipway while drawings 1-75001-1, 2 detail the proposed widening of a further 3m, i.e. total width of 6m. Drawing 1-71004-2 shows the location of the existing slipway. The structure is to be widened on the northwestern side to allow larger vessels the use of the haul out facilities.

(The broken radial lines on drawing 1-71004-2 show the proposed hardstand area - partly in use already).

Work on the widening of the slipway has already commenced with driving of piles and precasting concrete caps and slab.

I apologise for omitting to inform you of this proposal earlier.

Please find enclosed plan consideration fee of \$30-00.

Yours faithfully,
K.C.FENTON
CHIEF ENGINEER
THAMES-COROMANDEL DISTRICT

Per:.....

P.D. HIGGS
STAFF ENGINEER

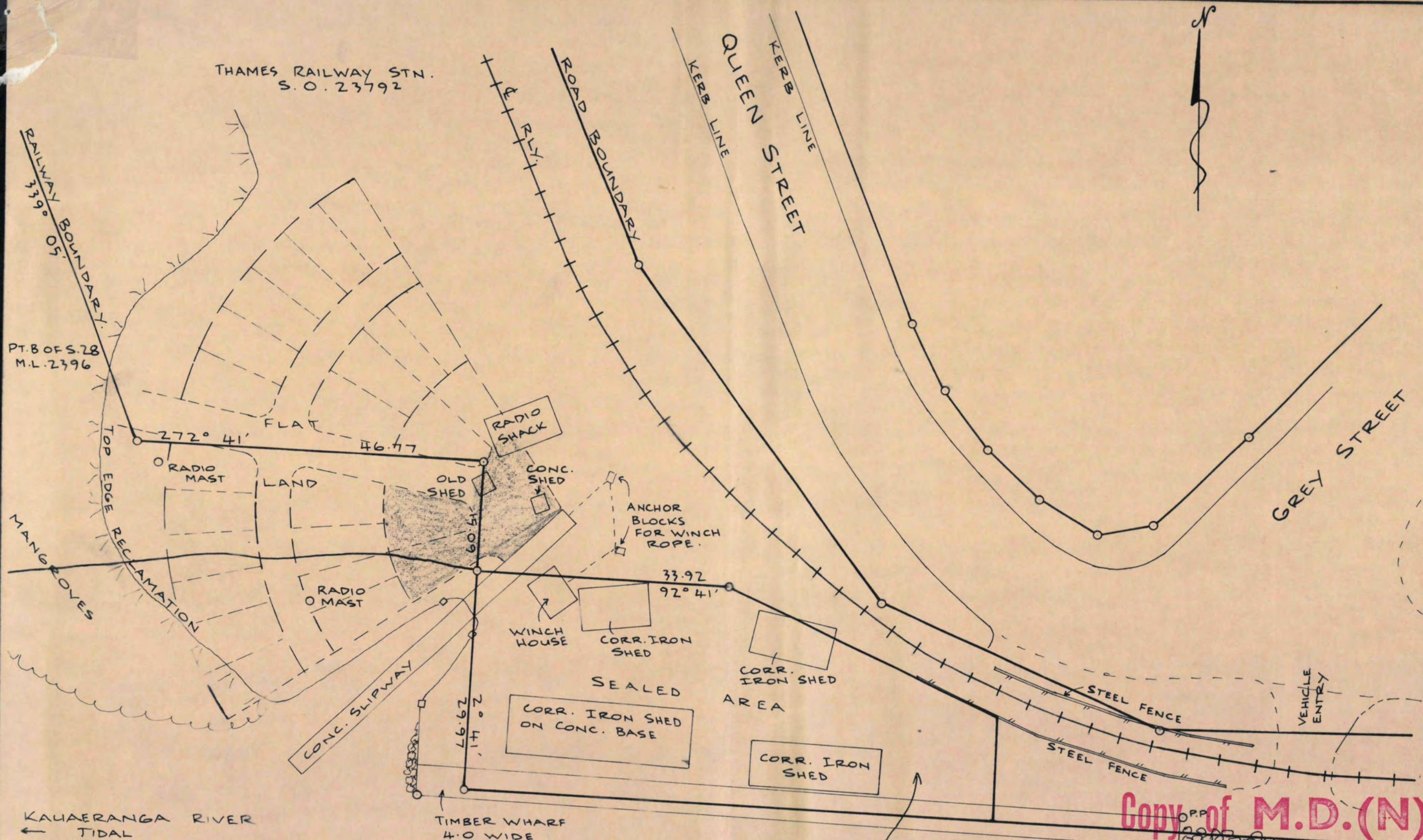

Copy of M.D.(N) 917
 SHEET (1) OF (5) 541/722

RLY. LAND GIVEN UP UNDER SPECIAL POWERS & CONTRACTS ACT, 1884, P. 351. (1846 m²) (NO EVIDENCE OF SURVEY)

F.W. MILLINGTON, M.N.Z.I.S. REGISTERED SURVEYOR THAMES.	SHORTLAND WHARF THAMES. MAP REF: T12/13.17	<div>SHEET 2</div> <div>1-71004-2</div> <div> <div>DRAWN</div> <div>TRACED</div> </div> <div> <div>CHECKED</div> <div>DATE 15/10/80</div> </div> <div> <div>SCALES</div> <div>1:500</div> </div>	<div>SHEET 2</div> <div>1-71004-2</div> <div>SERIES OF 2</div> <div>REF. T.481</div>

Wide format was located here in this file

To view the wide format image(s) please go to the end of this document

The numbers listed below are also on the wide format image(s) that belong here

6173

Wide format was located here in this file

To view the wide format image(s) please go to the end of this document

The numbers listed below are also on the wide format image(s) that belong here

6174

Wide format was located here in this file

To view the wide format image(s) please go to the end of this document

The numbers listed below are also on the wide format image(s) that belong here

6175

Wide format was located here in this file

To view the wide format image(s) please go to the end of this document

The numbers listed below are also on the wide format image(s) that belong here

6176

MINUTE SHEET

Department: NOT AKSubject: Reclamation: J.E. Davies:Section: H.F.Cnr Wyuna Bay Rd & Long Bay Rd,File No. 54/4 P41CoromandelDate: 7-9-82

49918A-15 pads/7/80 MK

To—

Your Reforce 54/16/0/5HEADOFFICES.E.O. (Hlas)Attn: T. Law

Further to your memo of the 1 September 1982
On the 5 May 1982 we sent you a copy
of a letter received from T.E.D.C. (another
copy enclosed) The letter mentioned your
file 54/16/0 and the fact that this
is not a reclamation. This office has
no idea what the letter is talking
about. Could you please investigate
and advise us if you require any
more information.

Item 504

J. M. Bear
for Regional Secretary

(File)

Thames - Coromandel District Council

TELEPHONE: 86-025 THAMES

PLEASE ADDRESS ALL CORRESPONDENCE TO: THE GENERAL MANAGER,
PRIVATE BAG, THAMES, N.Z.

If calling, please ask for

Mr Farquhar

Please quote reference.

V3/5

3 May 1982

The Regional Secretary for Transport,
Private Bag,
AUCKLAND

Attention: Mr Spackman

Dear Sir,

Re: "Reclamation" Corner Long Bay Road
and Wyuna Bay Coromandel

I have received a courteous reply from Mr Davies, to my letter of
25 April 1982.

Please consult your file 54/16/0 (Wellington file) for confirmation
from your Ministry on survey advice, that the work is not reclamation
and may proceed.

Yours faithfully,

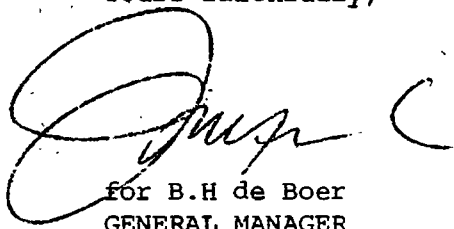
for B.H. de Boer
GENERAL MANAGER

FILED BY 
FILED NO. 16

File

40.
5/5/82

54/16/0/5

Regional Secretary
AUCKLAND

HEAD OFFICE

Attention: P.D. Spackman

1 September 1982

RECLAMATION : J.E. DAVIES : CORNER WYUNU BAY ROAD AND
LONG BAY ROAD, COROMANDEL

In April 1982 your forwarded a copy of a letter from the
Thames Coromandel District Council which enclosed a copy of
a letter sent by the Council to Mr J.E. Davies.

Would you please advise of any developments which have
occurred in respect of this matter.

411
T.E. Law
for Secretary for Transport

B/u 1/3/83 X

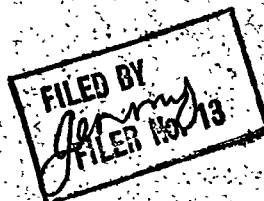

File

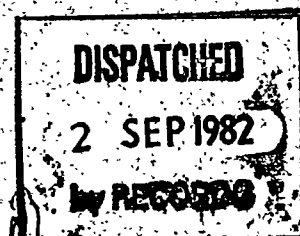

54/16/0/5
WIL: 22/3/2

1 September 1982

Director
Wildlife Service
Department of Internal Affairs
Private Bag
WELLINGTON

RECLAMATION AND RUBBISH TIPS ON TIDAL LAND:
COROMANDEL PENINSULA

Your memorandum of 24 June 1982 refers.

I wish to apologise for the delay in replying, however,
I understand that the matters which you raised are still
under investigation and discussion between the Auckland
office of this ministry and the Thames Coromandel District
Council.

tee
T.E. Law
for Secretary for Transport

File

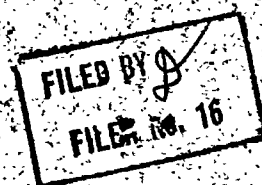



SEO(W/F)

54/16/0/5

Please Quote

WIL: 22/3/2

WILDLIFE SERVICE
DEPARTMENT OF INTERNAL AFFAIRS

Private Bag, Wellington, N.Z.

Telephone 738-699

Telegrams and Cables 'Internal'

24 June 1982

Harbours and Foreshore Division
Ministry of Transport
Private Bag
WELLINGTON

Attention: Miss A Ranger

RECLAMATION AND RUBBISH TIPS ON TIDAL LAND - COROMANDAL
PENINSULA

I refer to our letter of 14 January regarding the above.
Could you please advise whether you have as yet had an
opportunity to follow up any of the topics discussed.

(Brent Lyster)
for Secretary for Internal Affairs

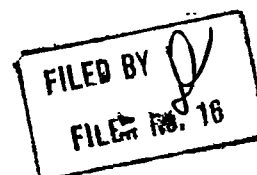

SEO.(H/F)

Could be on 54/16/6/5
54/4. Head File.

Thames - Coromandel District Council

TELEPHONE: 86-025 THAMES

PLEASE ADDRESS ALL CORRESPONDENCE TO: THE GENERAL MANAGER,
PRIVATE BAG, THAMES, N.Z.

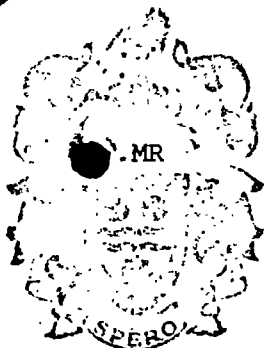

If calling, please ask for

Mr Farquhar

Please quote reference.

V3/5

23 April 1982

The Regional Secretary
of Transport,
Ministry of Transport,
Private Bag,
AUCKLAND



Dear Sir,

... I attach a copy of my letter to Mr Davies regarding your suggestion that an illegal reclamation is being carried out on the corner of Wyuna Bay Road and Long Bay Road, Coromandel.

I will advise you further when I hear from Mr Davies.

Yours faithfully,

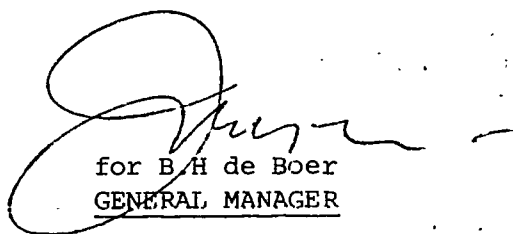
for B. H. de Boer
GENERAL MANAGER

Encl.



B/u 4/7/82

482

TO: Head Office
S.E.O. (Ahrs)

Attention: Miss Ranger

Copy for your information

Thames - Coromandel District Council

TELEPHONE 86-325 THAMES

JF.MR

PLEASE ADDRESS ALL CORRESPONDENCE TO: THE GENERAL MANAGER,
PRIVATE BAG, THAMES, N.Z.

If calling, please ask for

Mr Farquhar

Please quote reference.

V3/5

23 April 1982

Mr J.E Davies,
Colville
R.D.
COROMANDEL

Dear Sir,

The Ministry of Transport, Foreshores Division, is concerned that you are carrying out an illegal reclamation on your land at the corner of Wyuna Bay Road and Long Bay Road in Coromandel.

Will you please forward details of your intentions as to the development of this land, and the work you have done to date to me in order that I can consider whether the work falls within the provisions of the Harbours Act relating to reclamations, and advise you whether a reclamation authority is required.

The Ministry of Transport views illegal reclamations very seriously and will have no hesitation in prosecuting you if it considers that you have offended against the provisions of the Harbours Act.

Yours faithfully,

for B.H de Boer
GENERAL MANAGER



File

Our ref: 54/16/0/5
Your ref: WIL 22/6/7

29 January 1982

The Director
Wildlife Service
Department of Internal Affairs
Private Bag
WELLINGTON

FILE
29 1 82

Attention: K. Owen

**RECLAMATION AND RUBBISH TIPS ON TIDAL LANDS -
COROMANDEL PENINSULA**

Owing to the limited time available during my visit to Coromandel Peninsula I was unable to look at all of the areas described in your memo of 14 January. However, we were able to get an appreciation of illegal works being undertaken especially around the fringes of the Harbours, and the problems that road works carried out by MWD have caused.

A copy of your report has been sent to our Auckland office to follow up during the next field trip to Coromandel.

... Attached for your information is a copy of the map showing M.O.T Regional boundaries for harbours and foreshores work. If you have any further problems you would like the Ministry to follow up please do not hesitate to contact Regional Officers direct, if appropriate. The officers concerned are -

Northern Region - Peter Spackman
Central Region - David Le Marquand
Southern Region - Frank Lyons.

B.A. Ranger
for Secretary for Transport

Encl ✓

DISPATCHED

29 JAN 1982

by RECORDS

FILED BY
Jenny
15/1/82

2.

✓ Regional Secretary
Ministry of Transport
AUCKLAND ✓

Copy for your information and follow up.

Q
B.A. Ranger
for Secretary for Transport

DISPATCHED

29 JAN 1982

by RECORDS

86

FILED BY
amy
FILER 13/13

54/16/0

16 November 1981

The General Manager
Thames Coromandel District
Council
Private Bag
TAHAMES

Dear Sir

POLICY ON RECLAMATION

Your letter of 12 August 1981 refers and I apologise for the delay in replying.

An application for the building of a structure or reclamation over foreshore within your Council's jurisdiction should be forwarded by the applicant for prior consideration before Council forwards the plans to this Ministry for approval pursuant to the provisions of the Harbours Act 1950. However, there are times when applications are forwarded direct to this Ministry. When this happens this Ministry acknowledges receipt of the applications and advises the applicants that it has forwarded the application to Council for Council's consideration prior to any action being taken by the Ministry. The Council when it has given its support to an application would refer that application and plans to the Auckland Regional Office of the Ministry for consideration in terms of section 178 of the Act.

In respect of reclamations, the procedure which is followed by this Ministry is that close consultation is maintained with the Grant of Control authority and any comments made by that authority would be carefully considered when the Ministry decides the degree of support or otherwise that would be given to a proposal. The Ministry would not give its approval to any reclamation without first consulting the grant of control authority.

Concerning works carried out by the Crown, in the particular use in question, the Ministry of Works and Development in disposing of surplus clay material from roadworks the position is different from that already discussed. The Crown is not bound by the provisions of the Harbours Act 1950 and therefore legally no approval is required to be obtained for the Crown to carry out works over foreshore or tidal lands.

The Ministry has for some time recognised that Government works should achieve the same standard that is required of local authorities and others. This policy, which follows from departments' obligations under the Environmental Protection and Enhancement Procedures established by Cabinet in 1973, has been endorsed by the Minister of Transport. In 1978, the Secretary for Transport wrote to the Permanent Heads of all Departments engaged in foreshore works and advised that plans of such works should be forwarded to the Ministry for consideration pursuant to section 178 of the Act. Therefore the tenure of the Harbours Act should be complied with by all Government Departments.

It is obvious that certain problems arise in respect of the disposal of spoil within the area administered by your Council and to have this matter clarified, I have forwarded a copy of your letter of 12 August to the Auckland Office of this Ministry and have asked that the matter be taken up with the Ministry of Works and Development accordingly.

In answer to your specific questions I advise as follows:

1. This Ministry would appreciate advice of any illegal reclamation which come to Council's attention. The Harbours Act provides for remedies to be taken including prosecution or removal.
2. Yes. Where an application for any work is received, this Ministry will consult with Council as discussed above.
3. Yes, refer above.
4. No. The Harbours Act does not provide for general authorisations in the form discussed nor does it allow for approvals in principle.
5. An officer from the Auckland Office of this Ministry will be asked to meet with the Ministry of Works and Development to discuss the matters raised.
6. Answered above.

I trust that the above information is of assistance to you in your administration of the foreshore and tidal waters in terms of the Grant of Control.

Yours faithfully

T.E. Law
for Secretary for Transport

The Regional Secretary
AUCKLAND

Attention : P.D. Spaekman

Copy for your information together with a copy of the letter under reply. Would you please arrange to meet with the Ministry of Works and Development to discuss the matter of the spoil disposal.

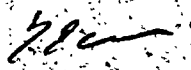
T.E. Law
for Secretary for Transport

Private Bag
Auckland
Telephone: 773-400

Custom House
Quay Street
Auckland

54/4

22 January 1980

The Manager
Thames Coromandel District
Council
Private Bag
THAMES

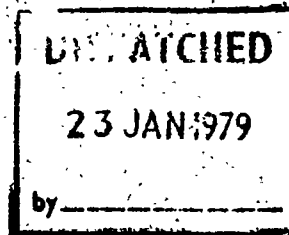

Dear Sir

PROPOSED RECLAMATION OF PART PURANGI RIVER ESTUARY
S.O. 50731

... Enclosed for your further action are two copies of
survey office plan No. 50731, returned to this office
by the Department of Lands and Survey.

Yours faithfully

P. D. Spackman
for Regional Secretary
for Transport

Encl:

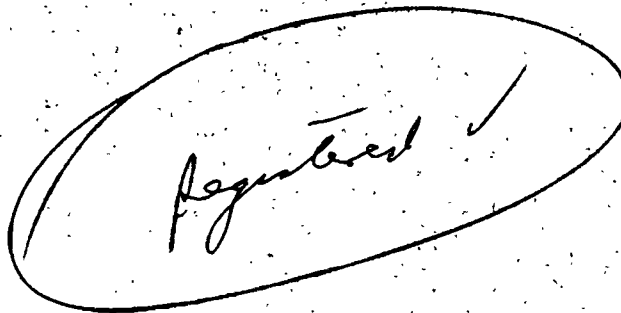

FILE - RETURN 54/4

DEPARTMENT OF LANDS AND SURVEY

TELEGRAPHIC ADDRESS: 'LANDS'

FOR VERBAL INQUIRIES
PLEASE ASK FOR MR P. Hudson

TELEPHONE No. 82-489



OUR REFERENCE: 9/1030

YOUR REFERENCE:

DISTRICT OFFICE,

P.O. BOX 460,

HAMILTON.

10th January 1980

Marine Division,
Ministry of Transport,
Regional Office,
Private Bag,
AUCKLAND.

Dear Sir,

Re: Proposed Reclamation of Part Purangi River Estuary - S.O. 50731.

The above plan has now been approved and forwarded herewith are two certified prints of the plan for your records.

Yours faithfully,

K.W. Walsh,
CHIEF SURVEYOR:

Per: 

Enc.

Return TCDC
to your further action



Thames - Coromandel District Council

TELEPHONE: 86-025 THAMES

PLEASE ADDRESS ALL CORRESPONDENCE TO: THE GENERAL MANAGER,
PRIVATE BAG, THAMES, N.Z.

If calling, please ask for
Mr Farquhar
Please quote reference.

54/4 P.S.

6 May 1986

The Secretary for Transport
Ministry of Transport
Private Bag
AUCKLAND

Attention Foreshore Division

Dear Sir

Your letter of 7 April refers.

The Council has noted your comments regarding the reclamation at Tairua. This work occurred when the old Paku jetty was demolished and the volunteers who carried out the demolition were apparently a little more enthusiastic than good sense would allow and placed the demolition materials from the job in this area to give a flying start to the reclamation proposed.

The Council would apologise for this happening before the formal application was made, and will take action to put the matter right.

The District Scheme has now been notified and the proposals to reclaim portion of the harbour at this point have now been made public.

I am having a formal application prepared to reclaim at this point in a manner which will compliment the future planning intentions for this area. The reclamation will not be particularly extensive and it will give an opportunity for meeting the vehicle parking needs and reserve areas adjacent to the beach at this point.

This reclamation is not designed to promote the Tairua-Pauanui Deep Sea Fishing Club's building proposal but rather to improve the public beach front facility at this point. With this application there will be a proposal to form the foreshore road, which is currently affected by strong tides and high seas in the harbour, to a level suitably high above the sea level to allow vehicle access to those properties fronting the harbour which previously have been unable to gain access.

The proposal will include a walkway which will link the Pepe area with the primary school along the beach front.

I am sorry that the dumping was carried out and I trust that this error will not prejudice the Council's case for a beach improvement project in this vicinity.

Yours faithfully

J Farquhar
Administration Officer
for GENERAL MANAGER



MS/JB

54/4 P+S
1/1/23/243-

HARBOURS & FORESHORES

7 April 1986

Administration Officer
Thames-Coromandel District Council
Private Bag
THAMES

Attention: Mr John Farquer

Dear Sir

NOTIFIED APPLICATION, TAIRUA PAUANUI DEEP SEA FISHING CLUB INC, TAIRUA

A site inspection of 2 April 1986 for the above discovered the existence of a recent unauthorised reclamation.

It appears that work in relation to Council's plans for the shoreline, as outlined in plan p.50 of the Tairua/Pauanui Planning Cell, has begun. As you know, the above application involves the siting of a Club House partly on this proposed Council reclamation.

This preliminary reclamation contravenes Section 176 of the Harbours Act 1950, and appears to constitute part of a development concept that has not been approved in terms of the Town and Country Planning Act 1977.

This Ministry requires Council to remove this unauthorised reclamation immediately.

Yours faithfully

M. H. Smythe
for Regional Secretary for Transport

MINUTE SHEET

Department:

Subject: Reclamation: J.E. Davies

Section:

Cnr Wyuna Bay Rd & Long Bay Rd,

File No: 54/4121

Commander

Date: 7-9-82

49918A-150 ds/7/80 MK

To-

Your Reference 54/16/0/5

HEAD

OFFICE

S.C.O. (Hkas)

ATTN: T. Law

Further to your memo of the 1 September 1982. On the 5 May 1982 we sent you a copy of a letter received from T.E. DC (another copy enclosed). The letter mentioned your file 54/16/0 and the fact that this is not a reclamation. This office has no idea what the letter is talking about. Could you please investigate and advise us if you require any more information.

J.M. Oar
for Regional Secretary



MINISTRY OF TRANSPORT

MOT 5

Our Ref:54/16/0/5.....

Your Ref:

INTERNAL MEMORANDUM

To Regional Secretary
AUCKLAND From HEAD OFFICE

..... Attention: P.D. Spackman Date: 1 September 1982

Subject: RECLAMATION : J.E. DAVIES : CORNER WYUNU BAY ROAD AND
LONG BAY ROAD, COROMANDEL

In April 1982 your forwarded a copy of a letter from the Thames Coromandel District Council which enclosed a copy of a letter sent by the Council to Mr J.E. Davies.

Would you please advise of any developments which have occurred in respect of this matter.

T.E. Law

T.E. Law
for Secretary for Transport





Thames - Coromandel District Council

TELEPHONE: 86-025 THAMES

PLEASE ADDRESS ALL CORRESPONDENCE TO: THE GENERAL MANAGER,
PRIVATE BAG, THAMES, N.Z.



If calling, please ask for

Mr Farquhar

Please quote reference.

V3/5

3 May 1982

The Regional Secretary for Transport,
Private Bag,
AUCKLAND

Attention: Mr Spackman

Dear Sir,

Re: "Reclamation" Corner Long Bay Road
and Wyuna Bay Coromandel

I have received a courteous reply from Mr Davies, to my letter of
25 April 1982.

Please consult your file 54/16/0 (Wellington file) for confirmation
from your Ministry on survey advice, that the work is not reclamation
and may proceed.

Yours faithfully,

for B.H de Boer
GENERAL MANAGER

Could be on
54/4. Head File.



Thames - Coromandel District Council

TELEPHONE: 86-025 THAMES

PLEASE ADDRESS ALL CORRESPONDENCE TO: THE GENERAL MANAGER,
PRIVATE BAG, THAMES, N.Z.

If calling, please ask for

Mr Farquhar

Please quote reference.

V3/5

23 April 1982

The Regional Secretary
of Transport,
Ministry of Transport,
Private Bag,
AUCKLAND



Dear Sir,

... I attach a copy of my letter to Mr Davies regarding your suggestion that an illegal reclamation is being carried out on the corner of Wyuna Bay Road and Long Bay Road, Coromandel.

I will advise you further when I hear from Mr Davies.

Yours faithfully,

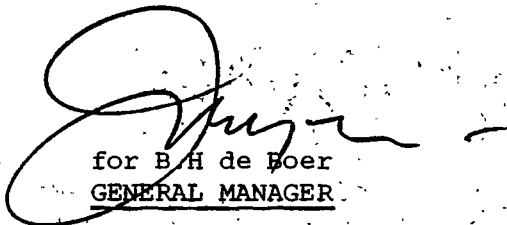
for B. H. de Boer
GENERAL MANAGER

Encl.

→ H.O.
29/4/82

Thames - Coromandel District Council

TELEPHONE: 86-025 THAMES

PLEASE ADDRESS ALL CORRESPONDENCE TO: THE GENERAL MANAGER,
PRIVATE BAG, THAMES, N.Z.

JF.MR

If calling, please ask for

Mr Farquhar

Please quote reference.

V3/5

23 April 1982

Mr J.E Davies,
Colville
R.D
COROMANDEL

Dear Sir,

The Ministry of Transport, Foreshores Division, is concerned that you are carrying out an illegal reclamation on your land at the corner of Wyuna Bay Road and Long Bay Road in Coromandel.

Will you please forward details of your intentions as to the development of this land, and the work you have done to date to me in order that I can consider whether the work falls within the provisions of the Harbours Act relating to reclamations, and advise you whether a reclamation authority is required.

The Ministry of Transport views illegal reclamations very seriously and will have no hesitation in prosecuting you if it considers that you have offended against the provisions of the Harbours Act.

Yours faithfully,

for B.H de Boer
GENERAL MANAGER

74.0.
29/4/82

JD.LN

PRIVATE BAG
AUCKLAND
TELEPHONE: 773.400

CUSTOMHOUSE
QUAY STREET
AUCKLAND

54/4 Pt 1

15 April 1982

Mr J. Farquar
Administration Officer
Thames-Coromandel District Council
Private Bag
THAMES

Dear Sir

RECLAMATION : CNR WYUNA AND LONG BAYS ROAD, COROMANDEL

Further to our letter of 24 March 1982.

This office would appreciate your urgent advice concerning the alleged illegal reclamation on the corner of Wyuna and Long Bays Road, Coromandel.

Have you been able to find any explanation concerning this reclamation?

Yours faithfully



J. H. Dean
for Regional Secretary for Transport

BRING-UP
16/5/82
Initials: Jma

Records

Please file 54/4 Pt 1

24/3/82.

Letter sent to Mr Faquar asking if
he has any more info. concerning
origin of this reclamation?
see file 54/20/29



Reclamation (illegal?) corner Wyuna
and Long Bays Road, Coromandel
Harbour 20.1.82

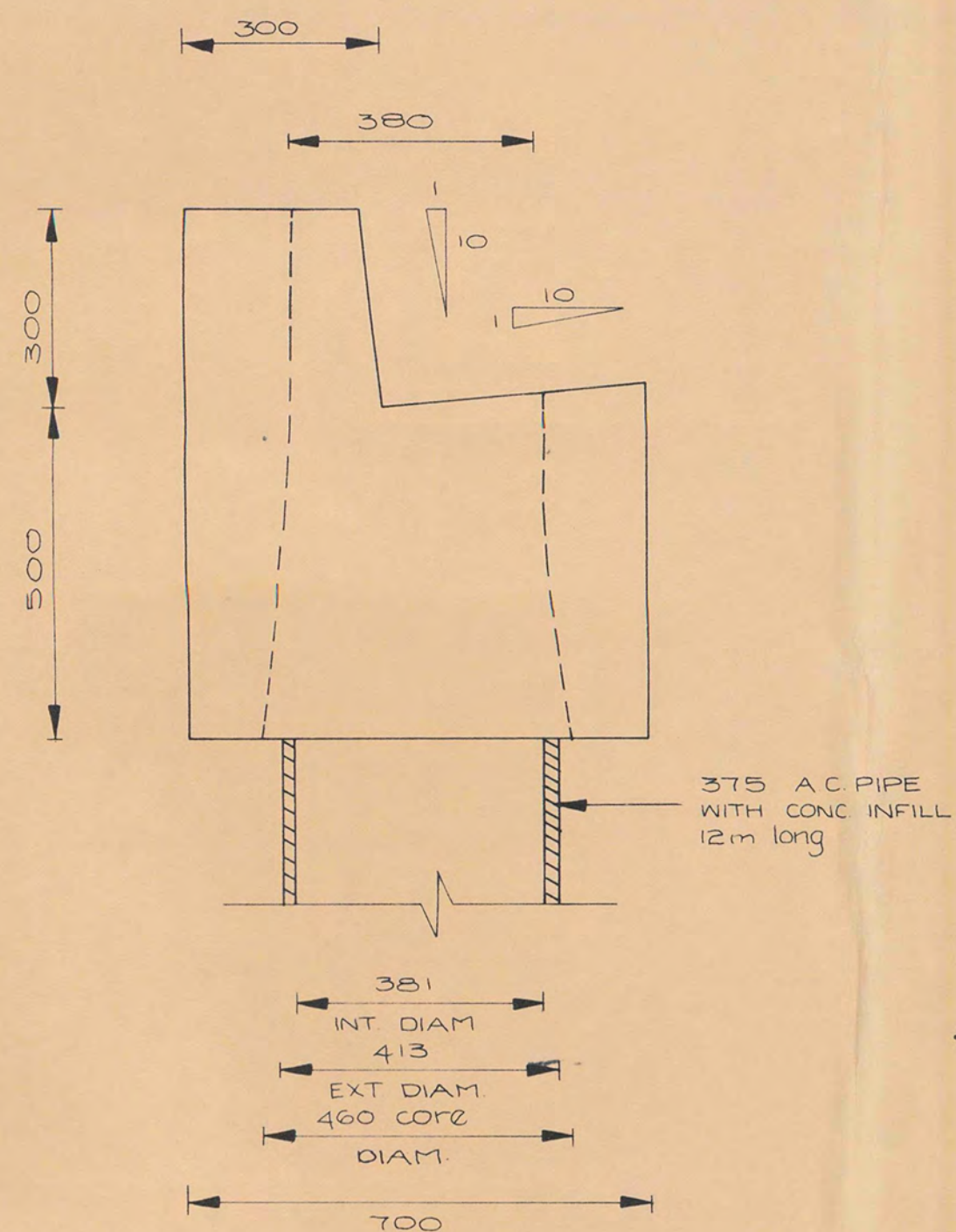

END ELEVATION

NOTES:

1. CAP SYMMETRICAL ABOUT £
2. UPPER CAP SIMILAR TO ONE SHOWN BUT WITHOUT UPSTAND
3. PILES TO BE PLACED FIRST AND "AS BUILT" PILE SPACING TO BE USED IN FORMING CORE HOLE IN PRECAST CAP
4. SURFACE OF PREFORMED CORE TO BE COATED WITH SURFACE RETARDER - "RUGASOL" OR EQUIVALENT TO PROVIDE TYPE "B" CONST. JOINT
5. PRECAST SLAB AS PER EXISTING WITH CORED HOLES FOR DOWELS POSITION TO SUIT
6. PRECAST CAP TO BE LIFTED BY EXPOSED 2001 BARS IN PREFORMED CORE

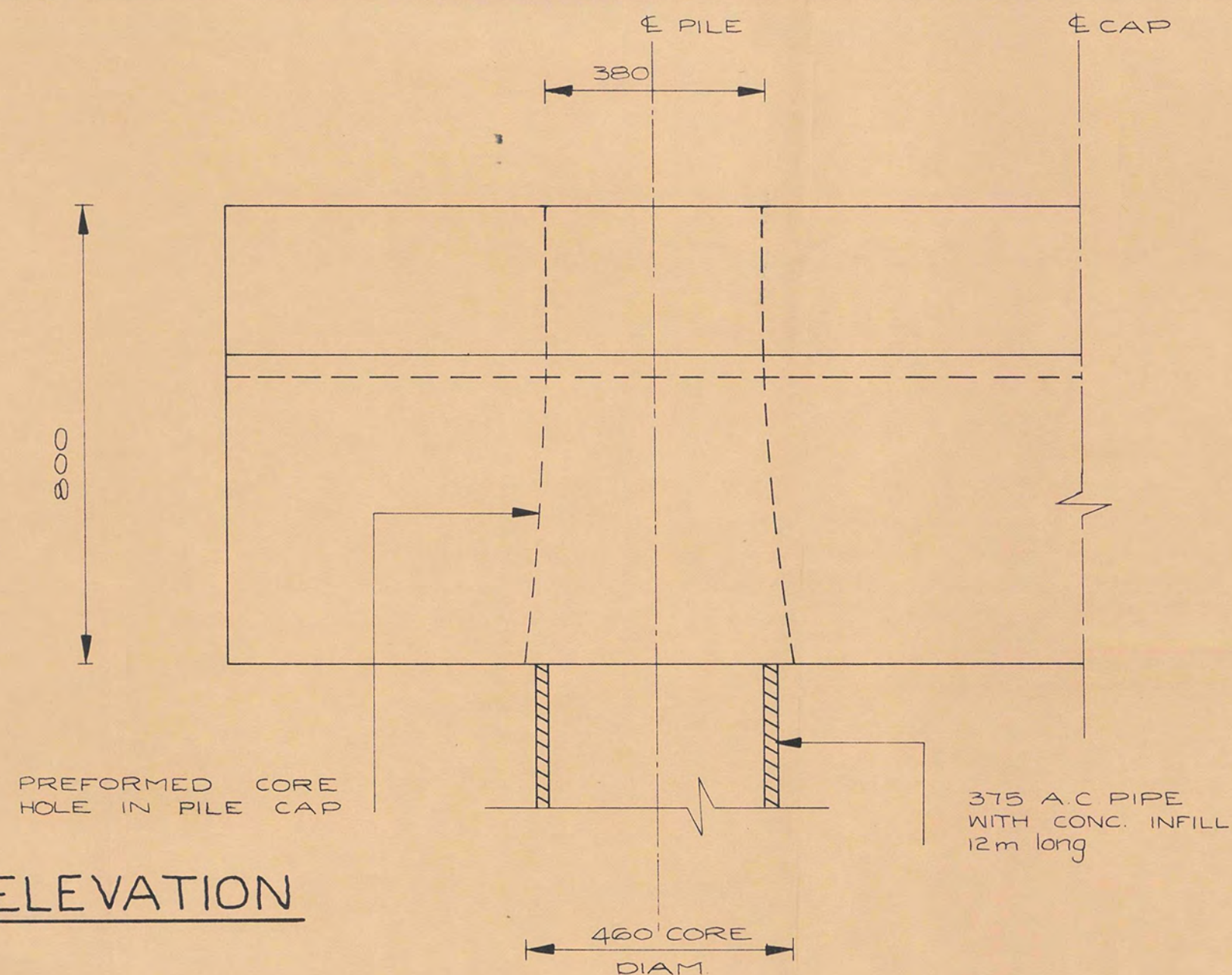

FRONT ELEVATION

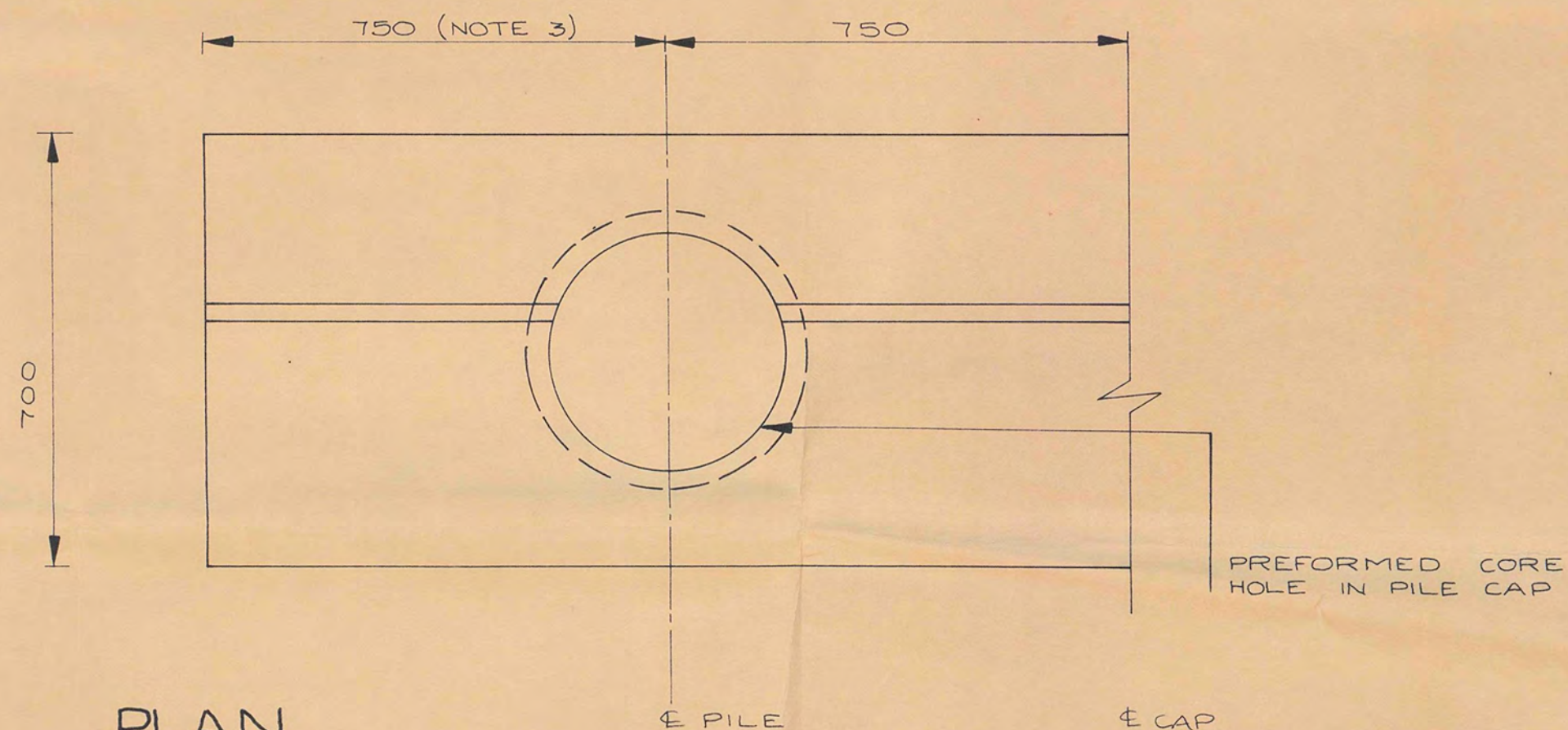

PLAN

6173

Copy of M.D.(N) 917

SHEET (2) OF (5)

54/11722

DESIGNED _____	DATE _____	THAMES COROMANDEL DISTRICT COUNCIL	THAMES WHARF SLIPWAY WIDENING	PILE CAP DIMENSIONS AND DETAILS	SCALES HOR 1:10 VERT _____
SURVEYED _____	_____				
DRAWN _____	_____				PLAN NO 1-75001-1
CHECKED _____	_____				
AMENDMENTS					

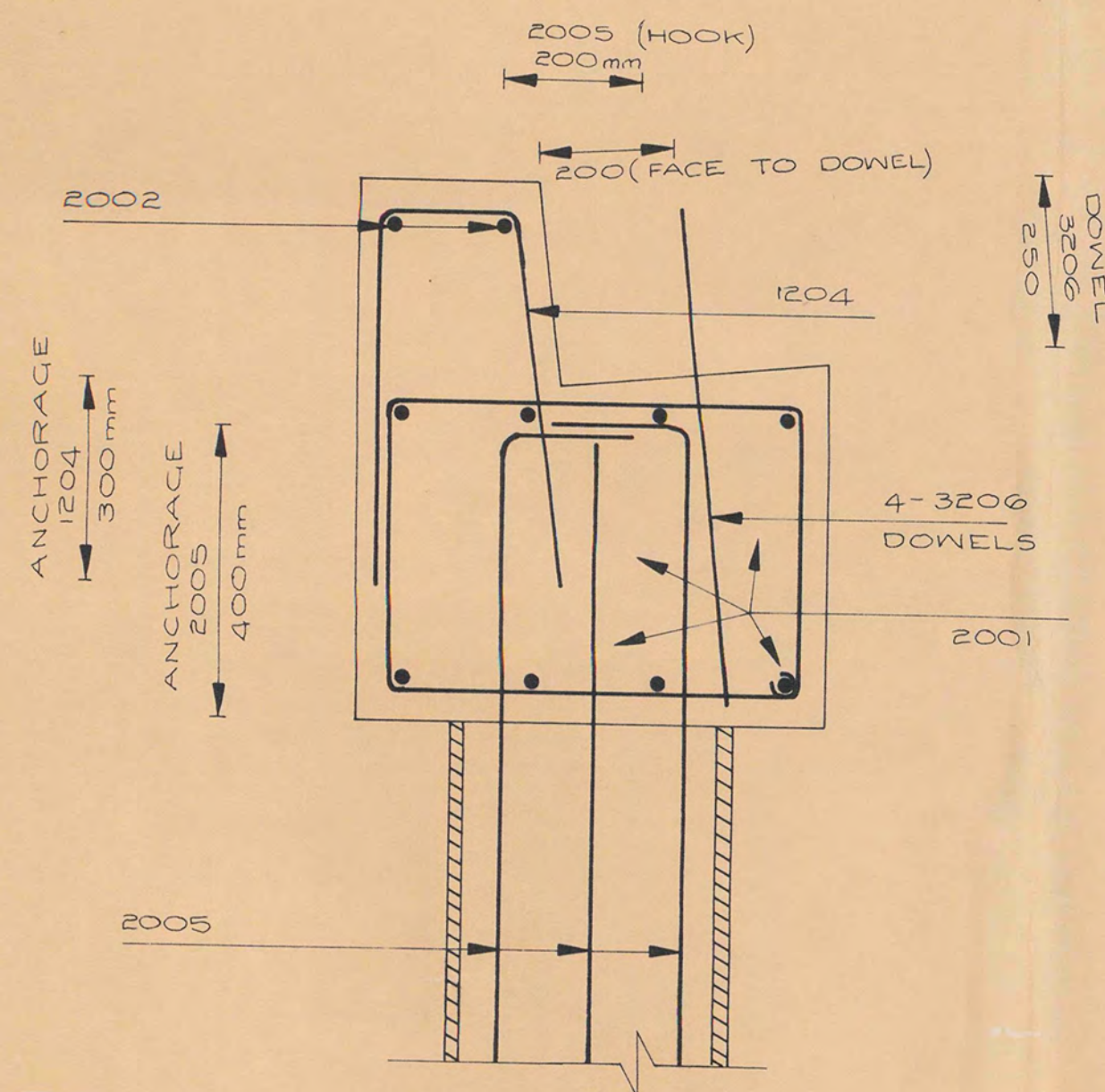

END ELEVATION

NOTES:

1. COVER TO MAIN REINFORCING PILES - 40mm
CAP - 50mm
2. CONCRETE STRENGTH $f'_c = 21$ MPa.
3. PILE REINFORCEMENT TO DEPTH OF 5.4m
4. PILE REINFORCING CAGE TO BE ORIENTATED AS SHOWN TO ALLOW CAP REINFORCING BARS TO BE CLEARED
5. E.S. - EQUALLY SPACED
T&B - TOP AND BOTTOM FACES

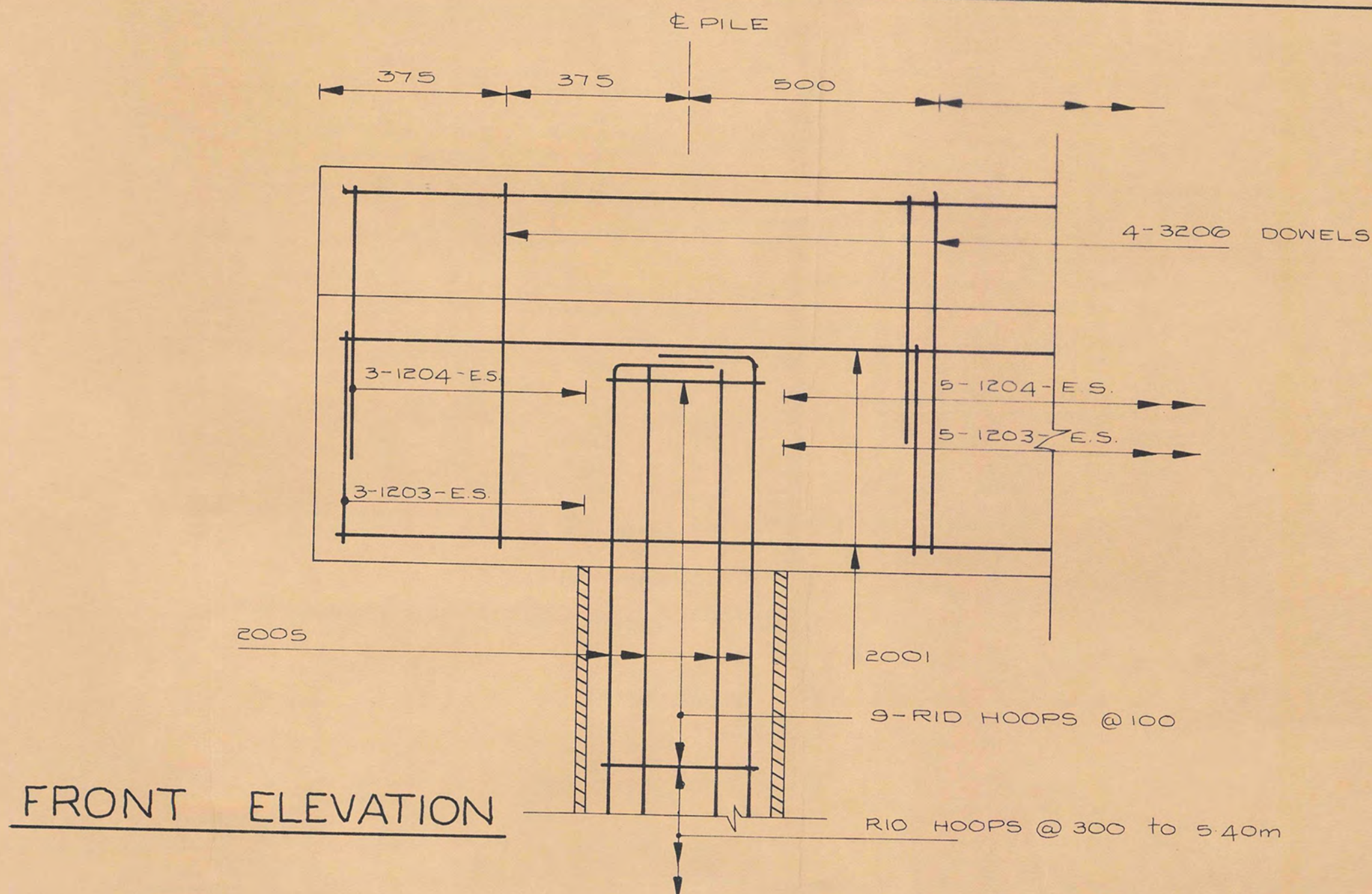

FRONT ELEVATION

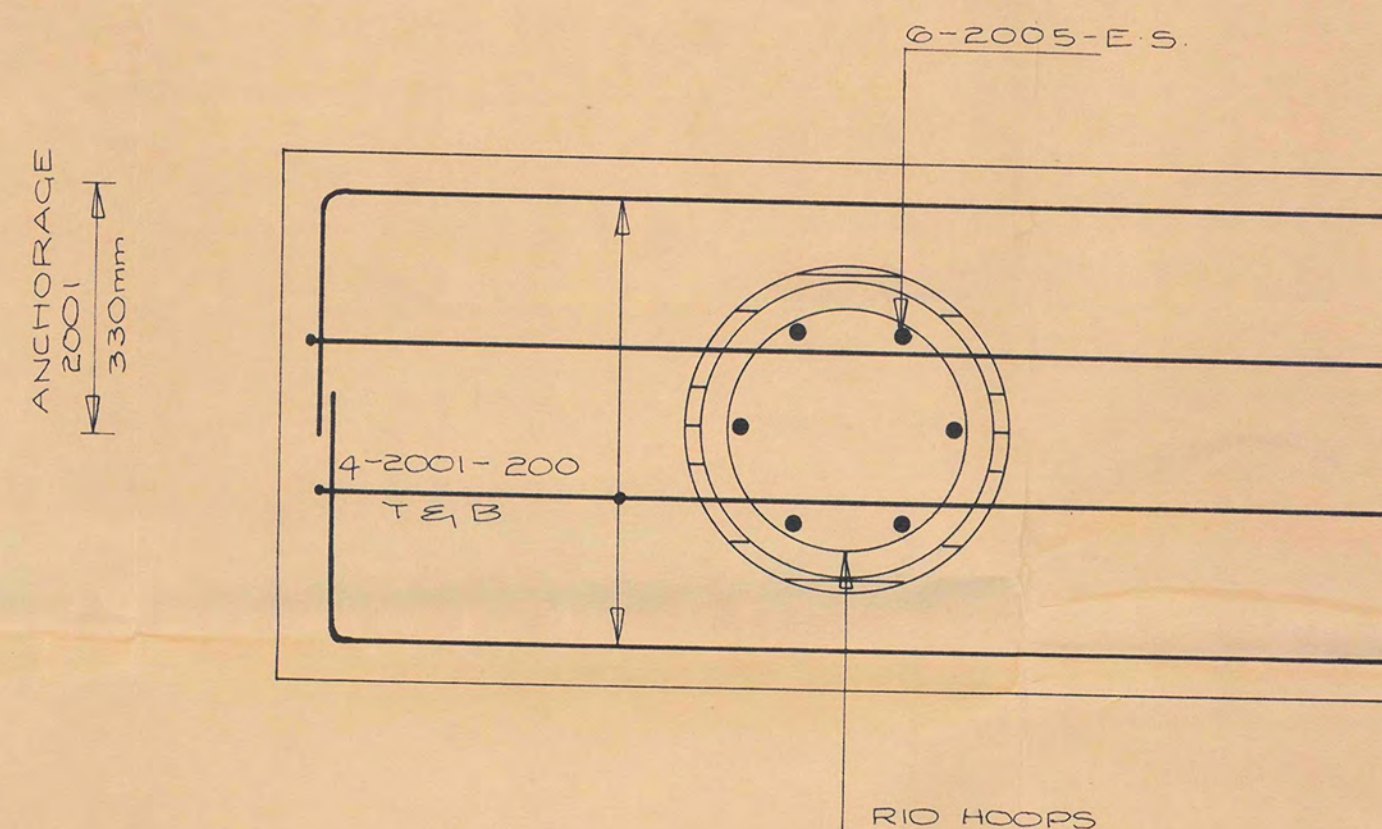

PLAN

6174

Copy of M.D.(N) 917

SHEET (3) OF (5)

5411722

DESIGNED _____	DATE _____	THAMES COROMANDEL DISTRICT COUNCIL	THAMES WHARF SLIPWAY WIDENING	SCALES HOR 1:10 VERT _____
SURVEYED _____	_____		PILE CAP & PILE REINFORCING DETAILS	
DRAWN _____	_____			PLAN NO
CHECKED _____	_____			1-75001-2
		AMENDMENTS		

approx M H W

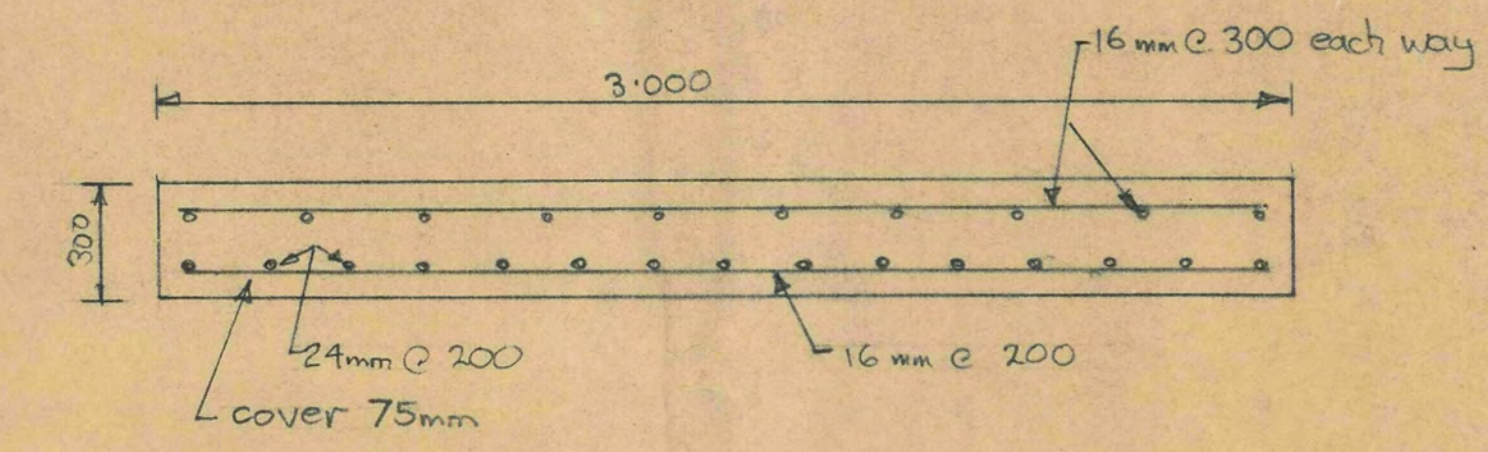

SECTION THROUGH PRECAST SLAB
 1:20

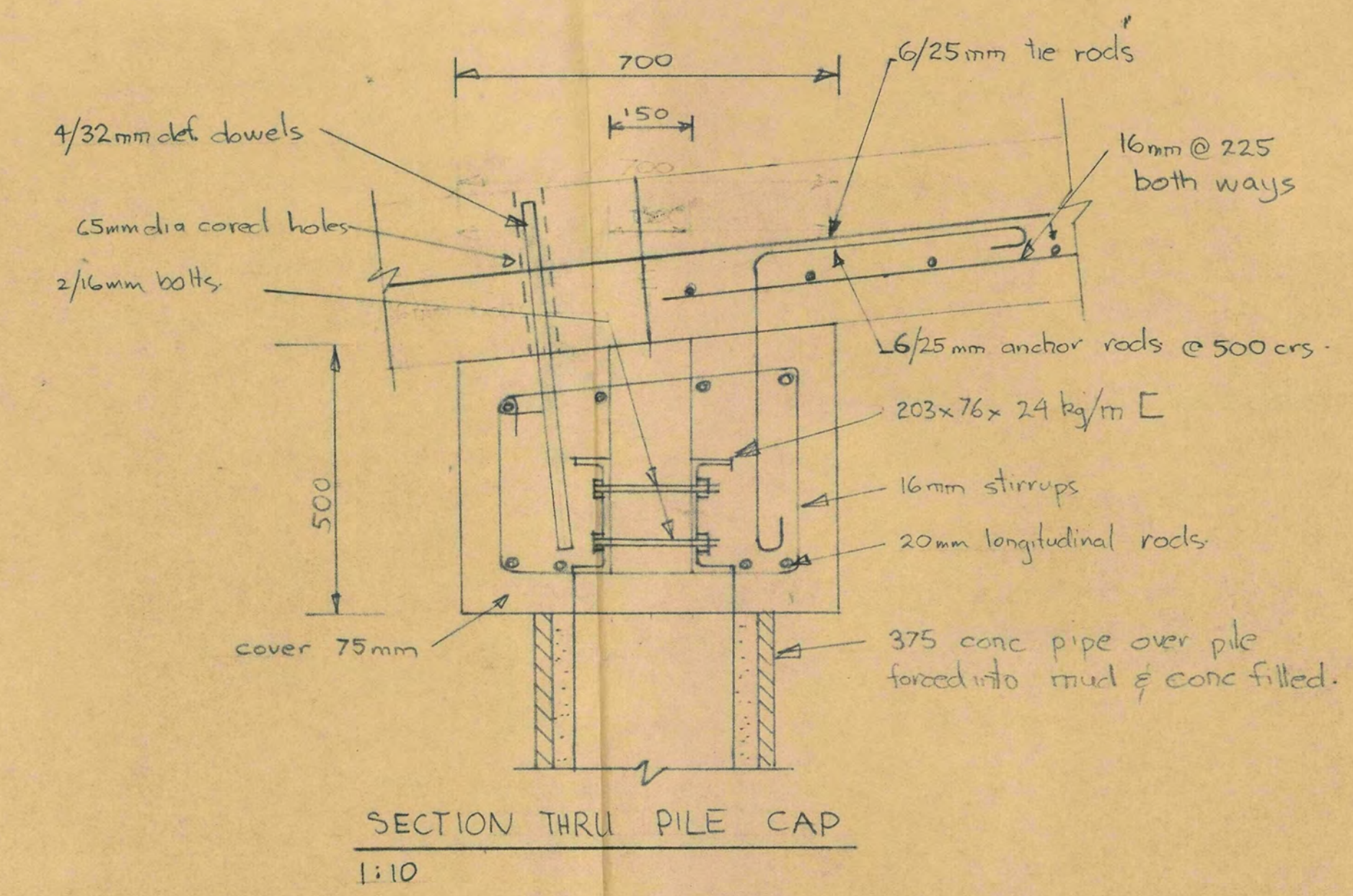
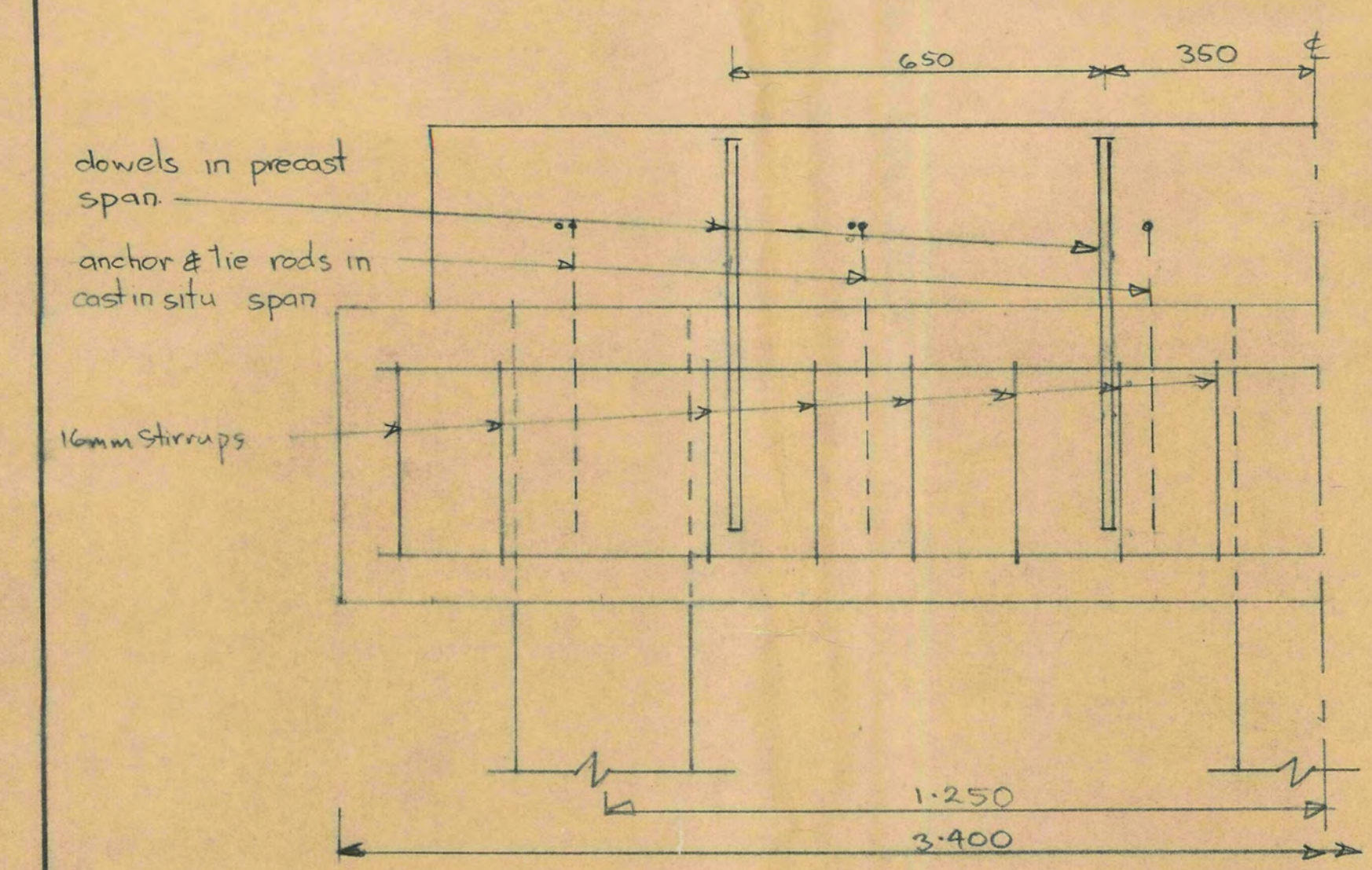
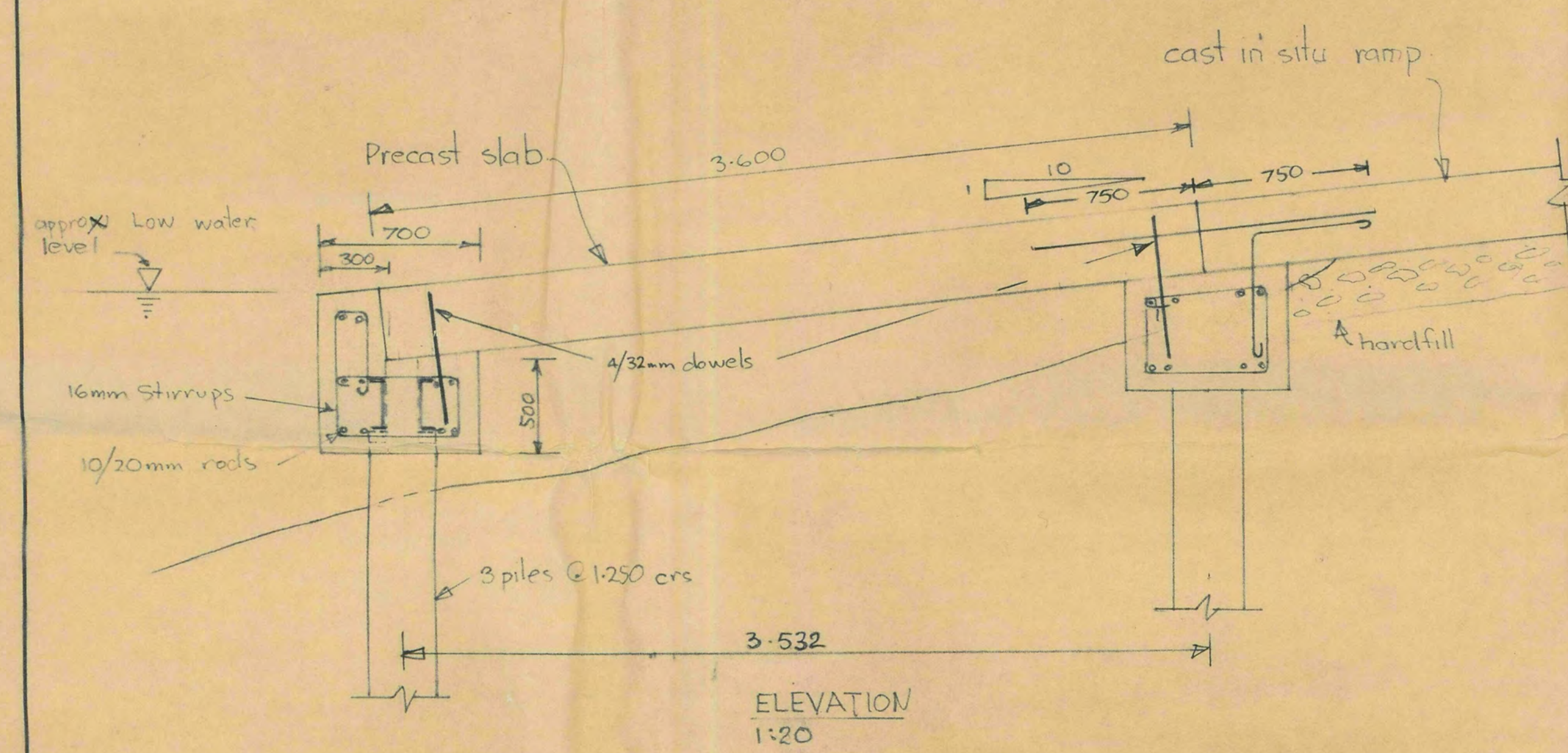

6175

Copy of M.D.(N) 917

SHEET (4) OF (5)
 54/11722

THAMES COROMANDEL
 DISTRICT COUNCIL

SHORTLAND WHARF - SUBWAY

1-71002-2

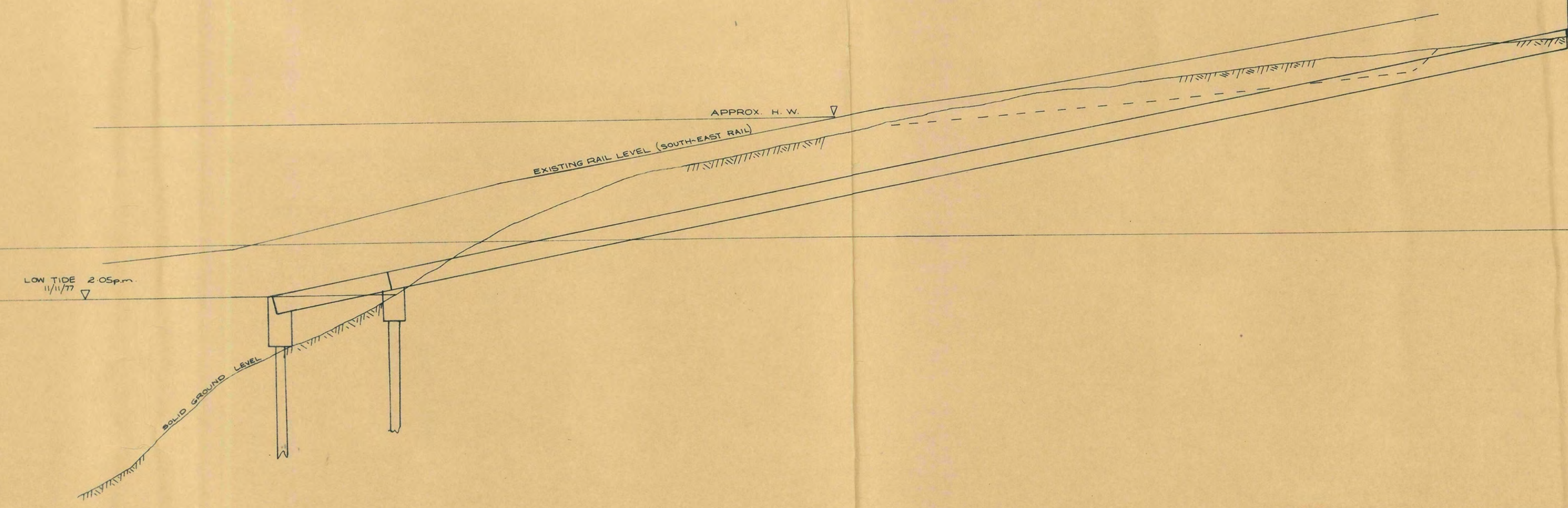
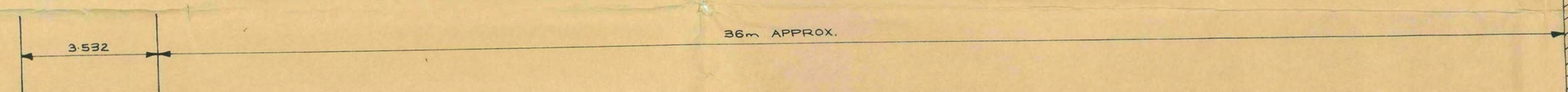
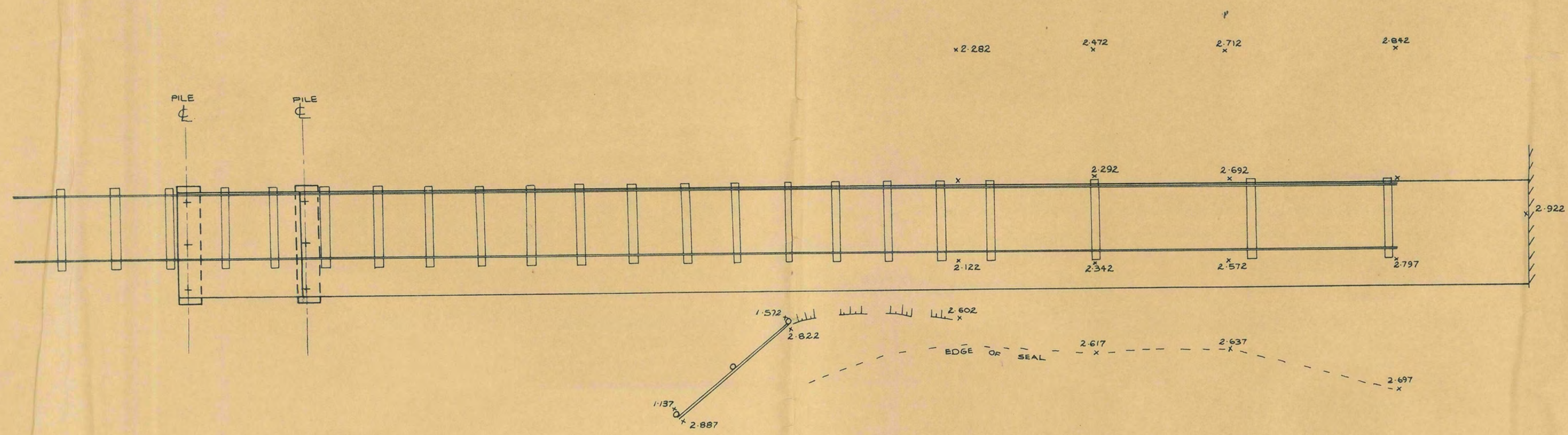

6176

Copy of M.D.(N) 917

SHEET (5) OF (5) 54/11/72

Plan No.:	THCC/
File:	

Drawing References	Approved
	County Engineer
	Date

THAMES COUNTY COUNCIL	
THAMES WHARF PROPOSED SLIPWAY RENEWAL	

Scale: Horizontal 1:100 Vertical 1:50	
Sheet	of Sheets
Date	
Drawn	
Traced	
Checked	
File:	
Plan No.	
THCC/	1-71002-1